



Water resistant USB Camera

WAT-03U2D

Operation Manual

This operation manual covers safety, camera functions, installation and the correct operating procedure for the WAT-03U2D. First, we ask you to read this operation manual thoroughly, then install and operate the WAT-03U2D as advised. In addition, for future reference, we also advise safekeeping of this manual.

Please contact the distributor or dealer from which the WAT-03U2D was purchased, if you do not understand the installation, operation or safety instructions laid out in this manual. Not understanding the contents of the operation manual sufficiently may cause damage to the camera.

Guide to the Safety Symbols

The definitions of the symbols used in this operation manual are:



When you do not adhere to or take notice of the "Danger" sign, it may lead to a serious accident such as death or injury caused by fire or electric shock.



When you do not adhere to or take notice of the "Warning" sign, it may cause severe damage such as a physical injury.



When you do not adhere to or take notice of the "Caution" sign, it may incur injury and cause damage to peripheral objects in the immediate surroundings.

Cautions for Safety

The WAT-03U2D is designed to be used safely; however, if not used safely, it may lead to a physical accident caused by fire and electric shock. Therefore, please keep and read the "Cautions for safety" below for protection against accidents.



- Do not disassemble and/or modify the WAT-03U2D.
- Do not operate the WAT-03U2D with wet hands.



- Do not use the WAT-03U2D under unusual environmental conditions. The WAT-03U2D is specified as waterproof. However, the WAT-03U2D is not compliant with dust-proof and explosion-proof standards.
- Protect the WAT-03U2D from condensation. Keep the WAT-03U2D dry at all times during storage and operation.
- Should the camera not work properly, switch off the power immediately. Then check the camera according to the "Problems and Trouble shooting" section.



- Avoid the striking of hard objects or dropping the WAT-03U2D. The WAT-03U2D uses high quality electrical parts and precision components.
- Do not install the WAT-03U2D in a position subject to direct sunlight. Sunlight shining directly onto the WAT-03U2D lens can cause damage to the image sensor.
- Select a stable place for installation of the WAT-03U2D. Use a support of durable strength around an installation position on a ceiling or wall when a camera stand or tripod is used.
- Do not move the WAT-03U2D with the cables connected. Before moving the WAT-03U2D, always remove the cable from the rear of the camera first.
- Avoid using the WAT-03U2D near any strong electromagnetic field. Avoid emission sources of electromagnetic waves when the WAT-03U2D is installed into main equipment.

- Dry the WAT-03U2D well after use. When the WAT-03U2D is used in seawater, flush well with pure water, and then wipe. If the WAT-03U2D is steeped in water for many hours or left without wiping after use, the surface of the WAT-03U2D may become white.

Problems and Trouble Shooting

If any of the following problems occur when using the WAT-03U2D,

- An optimal picture cannot be obtained, after checking that all the cables and connections are correctly in place
- Smoke or any unusual odor emerges from the WAT-03U2D
- An object becomes embedded or a quantity of liquid seeps into the camera housing
- More than the recommended voltage or/and amperage has been applied to the WAT-03U2D by mistake
- Anything unusual occurring to any equipment connected to the WAT-03U2D

Disconnect the camera immediately according to the following procedures;

- ① Remove the cables connected to the WAT-03U2D.
- ② Contact the distributor or dealer from which the WAT-03U2D was purchased.

About EMC

The WAT-03U2D is in conformity with EMC test standards carried out by authorized organizations in Japan.

FCC Part15 class B
EN55032 / EN55024

※ Compliance with EMC standards are confirmed using components/peripheral accessories included with the camera.



Do not modify the WAT-03U2D. A modified camera may not conform to EMC test standards.

Note: This equipment has been tested and found to comply with the limits for a Class B digital device, pursuant to part 15 of the FCC Rules. These limits are designed to provide reasonable protection against harmful interference in a residential installation. This equipment generated, uses and can radiate radio frequency energy and, if not installed and used in accordance with the instructions, may cause harmful interference to radio communications. However, there is no guarantee that interference will not occur in a particular installation. If this equipment does cause harmful interference to radio or television reception, which can be determined by turning the equipment off and on, the user is encouraged to try to correct the interference by one or more of the following measures:

- Reorient or relocate the receiving antenna.
- Increase the separation between the equipment and receiver.
- Connect the equipment into an outlet on a circuit different from that to which the receiver is connected.
- Consult the dealer or an experienced radio/TV technician for help.

Watec, Inc.
557 Oregon Trail, Pine Bush, NY 12566, U.S.A
TEL: +1-845-359-1490 FAX: +1-845-359-1391

Waterproof Conformity

The external body of the WAT-03U2D is in conformity with the following waterproof standard.

JIS C 0920 (IEC60529)
Degrees of protection provided by enclosures: IPX7

※ Waterproof capability of the WAT-03U2D is confirmed according to the above conditions. This waterproof standard does not cover the quality of the operation under unusual condition.



For ⑤USB micro-B CONNECTOR, this part is not included in the compatible range of the waterproof standard. Treat the connector area for waterproofing if needed.

Contents

Using the contents figures below, make sure all parts are present before use.

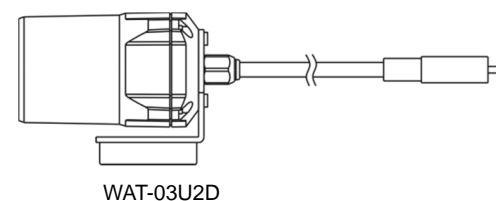

Description of Parts

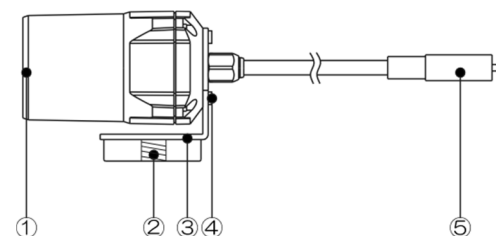

- ① FRONT GLASS (Tempered glass)
Dirt, water or oil deposits on the front glass will cause an unclear picture on the monitor and scratches might become permanent damage. Do not dismount the front glass.
- ② TRIPOD MOUNTING SCREW HOLES
Mounting holes for stands. The size of these threads are 1/4", 20 threads, 4.5±0.2mm, which is the same as any standard camera tripod (U1/4").
- ③ BRACKET
The screws for mounting the bracket to the camera.
- ④ BRACKET MOUNTING SCREWS
The screws for mounting the bracket to the camera.
- ⑤ USB micro-B CONNECTOR
For USB connection.

Set-up and Operation

- 1) Connect WAT-03U2D with the PC, using an attached cable.
- 2) Start the software application and adjust the lens while viewing the image displayed.
- 3) When a change of installation position is required, set ③BRACKET to your required position after removing ④ BRACKET MOUNTING SCREWS from the WAT-03U2D, then retighten ④ BRACKET MOUNTING SCREWS firmly. Angular settings for ceiling and wall are also available.

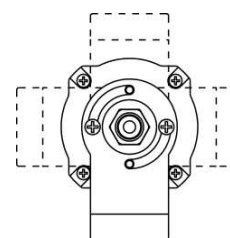

Contact information

- Design and specifications are subject to change without notice.
- Watec is not responsible for any inconvenience or the attendant damages to the video and monitoring recording equipment caused by misuse, mis-operation or improper wiring of our equipment.
- If for any reason the WAT-03U2D does not work properly, or if you have any questions regarding installation or operation, please contact the distributor or dealer from which it was purchased.

Contact information

Watec Watec Co., Ltd.

Addr.: 254-2 Nihonkoku, Daihoji, Tsuruoka- Shi,
Yamagata-Ken, 997-0017 Japan
TEL: +81-235-23-4400 FAX: +81-235-23-4409
Email: info-o@watec.co.jp
URL: http://www.watec.co.jp

5120Z00-Y2000004